

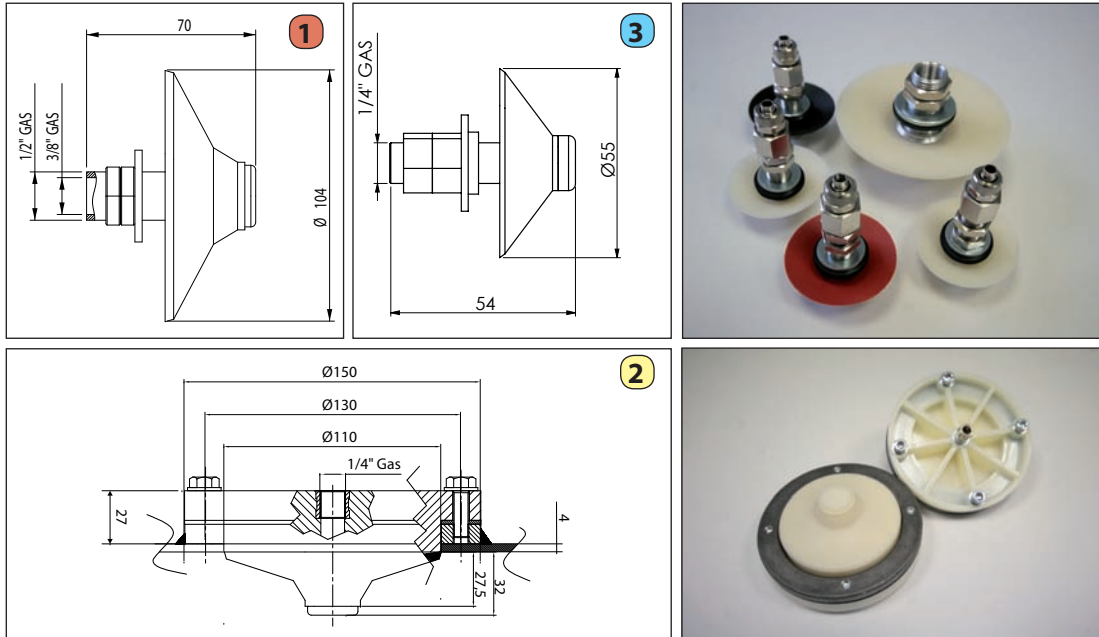

TECHNICAL DATA SHEET



Type	Draw.	Features							
		Air consumption							
		1 bar (14.5 psi)		2 bar (29 psi)		4 bar (58 psi)		6 bar (87 psi)	
		L/min	Cfm	L/min	Cfm	L/min	Cfm	L/min	Cfm
VB - VBI	1	-	-	100	3.53	150	5.29	250	8.82
VBE	2	-	-	100	3.53	150	5.29	250	8.82
VBM - VBIM	3	50	1.8	70	2.47	-	-	-	-

APPLICATION	HOPPER AND SILO - TUBE - TRAILER TANK
POWDER	DRY - FINE - GRANULAR
PROBLEM SOLVING	BRIDGE AND RAT-HOLING
FEATURES	
DUTY CICLE	DISCONTINUOUS
WORKING PRESSURE	FROM 2 BAR TO 6 BAR (FROM 29 PSI TO 87 PSI) VBM-VBIM FROM 1 BAR TO 2 BAR (FROM 14.5 PSI TO 29 PSI)
PNEUMATIC CIRCUIT	FILTER+FLOW CONTROL VALVE
AIR SUPPLY QUALITY	CLASS 5.4.1.
WORKING TEMPERATURE	VB - VBI - VBM - VBIM FROM -40°C TO 170°C (FROM -40°F TO 338°F) VBE FROM -40°C TO 80°C (FROM -40°F TO 176°F)
TECHNOLOGY	VIBRO-FLUIDIFICATION
MATERIAL	SILICONE MEMBRANE [FOOD GRADE] ALUMINUM / STAINLESS STEEL STEM PDM GASKET NYLON BODY WITH STEEL RING [VBE]
OPTION	
EXTERNAL MOUNTING KIT	AVAILABLE
HIGH TEMPERATURE MEMBRANE	RED COLOUR
BLACK COLOR MEMBRANE	AVAILABLE