



OZB SLIDE VALVES

PRECISION ENGINEERING FOR SEAMLESS MATERIAL FLOW

Enhance the efficiency of your material handling operations with OZB Slide Valves, are designed and manufactured to facilitate smooth flow and precise control of bulk solid materials. Whether you're managing silos, hoppers, weighing hoppers, or screw conveyors, our slide valves offer unparalleled performance and versatility.



KEY FEATURES

Versatile Design: OZB Slide Valves are available in square (SVQ), round (SVC), and rectangular (SVR) sections, catering to a wide range of application needs.

Robust Construction: Crafted from durable carbon steel, these slide valves ensure longevity and reliability, with options for galvanized or stainless-steel bodies and blades.

Optimised Performance: Equipped with EPDM (synthetic rubber made from the chemicals) chutes and precision-engineered blades, Bulkquip distributed slide valves deliver seamless material flow and precise control in any environment.

Flexible Operation: Choose from manual, pneumatic, or electric swivel drive actuators to suit your operational requirements, ensuring effortless control and adjustment.

UNIT DESCRIPTIONS

Valve Functionality: Slide valves serve as indispensable components for discharging and controlling the flow of bulk solid materials within channels, offering unmatched reliability and efficiency.

Customised Control: Slide valves enable seamless adjustment or complete shutdown of material flow within silos, hoppers, and similar enclosed volumes, providing tailored solutions for your specific needs.

Discover Unmatched Versatility: Bulkquip understand the importance of seamless material flow and precise control in industrial environments. With the Bulkquip range of slide valves, available in various sections and configurations, you can optimise your material handling processes.

Experience Excellence in Material Handling: Transform your material handling capabilities with Bulkquip distributed Slide Valves, engineered to meet the demands of the most challenging environments. Trust in our expertise and commitment to quality for unparalleled performance and reliability in every operation.

NOMINAL VALVE SIZE

150	150mm
200	200mm
250	250mm
300	300mm
350	350mm
400	400mm

Body Material is stainless steel AISI 304

Chute Material is stainless steel AISI 316

COMPOSITION

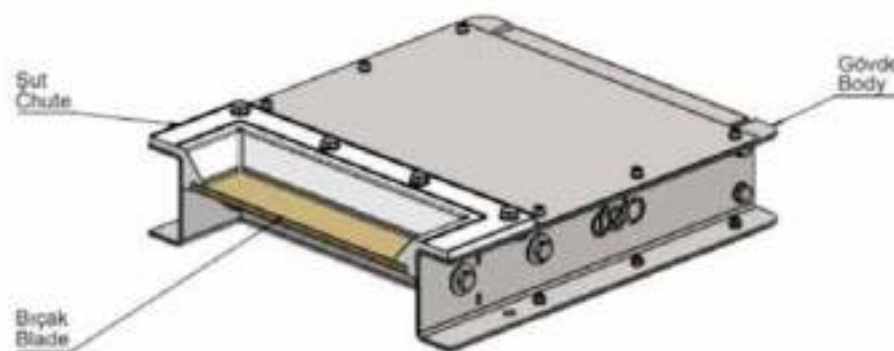

Type	Body	Chute	Blade
SVQ-C-R...13A	Galvanised	EPDM	Galvanised
SVQ-C-R...13B	Galvanised	EPDM	Stainless Steel AISI 304
SVQ-C-R...23B	Stainless Steel AISI 304	EPDM	Stainless Steel AISI 304

OVERALL DIMENSIONS

Square Section Slide Valves

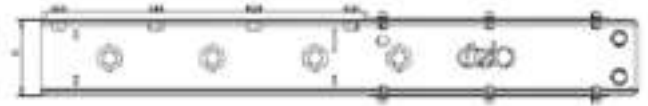
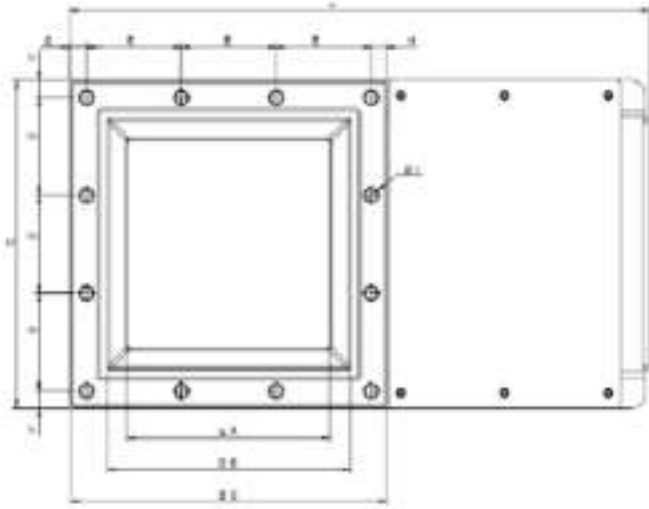

Type	A (mm)	B (mm)	C (mm)	D (mm)	E (mm)	F (mm)	G (mm)	H (mm)	ØI (mm)	J (mm)	K (mm)	Bolts	Weight (kg)
SVQ 150	120	174	260	261	115.0	15.5	15.5	15.0	12	462	100	M10	13.3
SVQ 200	170	224	310	311	93.4	15.5	15.5	15.0	12	565	100	M10	18.0
SVQ 250	225	279	360	361	110.0	15.5	15.5	15.0	12	659	100	M10	22.1
SVQ 300	275	329	427	431	128.3	23.1	23.1	21.1	12	784	100	M10	28.2
SVQ 350	320	374	474	475	89.0	15.0	15.0	14.5	12	915	114	M10	36.0
SVQ 400	370	424	530	531	100.0	15.5	15.5	15.0	12	1005	114	M10	42.9

SVQ-150-200-250: 3x2=6pcs bearing

SVQ-300: 4x2=8 pcs bearing

SVQ-350-400: 5x2=10 pcs bearing

Round Section Slide Valves

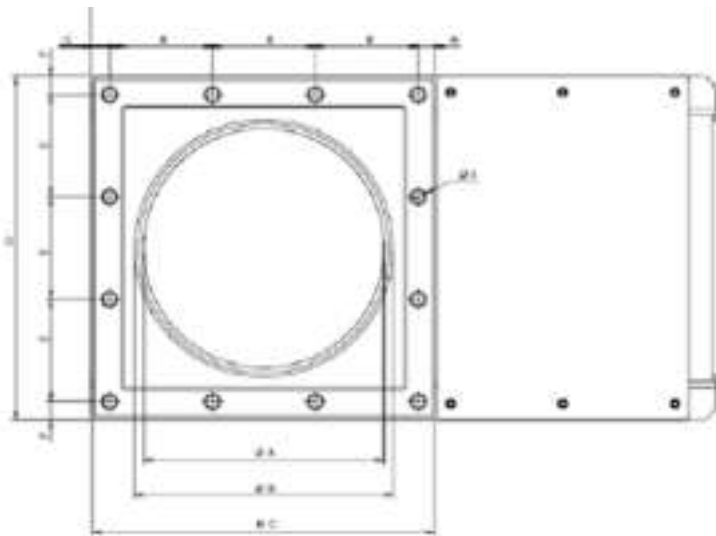

Type	ØA (mm)	ØB (mm)	C (mm)	D (mm)	E (mm)	F (mm)	G (mm)	H (mm)	ØI (mm)	J (mm)	K (mm)	Bolts	Weight (kg)
SVC 150	150	173	260	261	115.0	15.5	15.5	15.0	12	462	100	M10	13.3
SVC 200	200	223	310	311	93.4	15.5	15.5	15.0	12	565	100	M10	18.0
SVC 250	250	273	360	361	110.0	15.5	15.5	15.0	12	659	100	M10	22.4
SVC 300	300	322	427	431	128.3	23.1	23.1	21.1	12	784	100	M10	26.0
SVC 350	350	373	474	475	89.0	15.0	15.0	14.5	12	915	114	M10	36.0
SVC 400	400	423	530	531	100.0	15.5	15.5	15.0	12	1005	114	M10	43.6

SVC-150-200-250: 3x2=6 pcs bearing

SVC-300: 4x2=8 pcs bearing

SVC-350-400: 5x2=10 pcs bearing

Rectangle Section Slide Valves

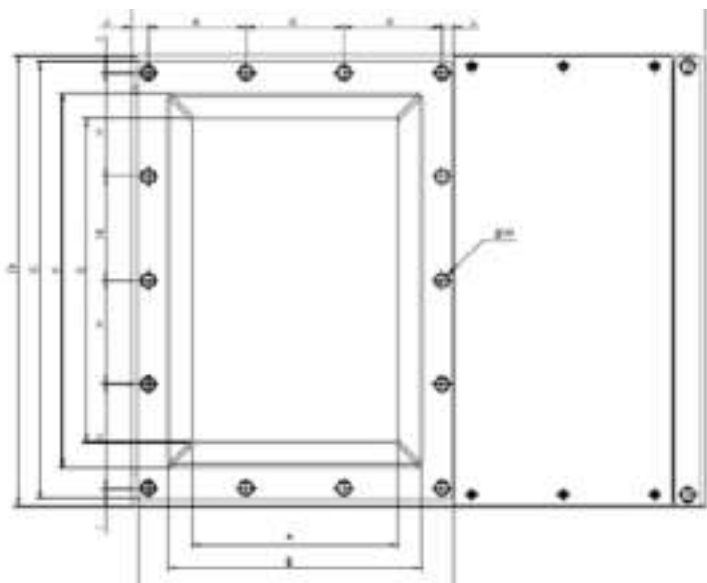

Type	A (mm)	B (mm)	C (mm)	D (mm)	E (mm)	F (mm)	G (mm)	H (mm)	ØI (mm)	J (mm)	K (mm)	L (mm)	M (mm)	N (mm)	Bolts	Weight (kg)
SVR 200	170	230	302	424	413	336	280	98	16	15.5	93.3	11.1	548	100	M10	22.4
SVC 300	270	334	413	592	574	489	425	136	24	22	128	14.4	753	100	M10	18.0

SVR-200: 3x2=6 pcs bearing

SVR-300: 4x2=8 pcs bearing

ACTUATORS FOR SLIDE VALVES

Slide valves can be used with manual, pneumatic or electric swivel drive actuators as needed.

Pneumatic Actuators		ACPS150	ACPS200	ACPS2503	ACPS3003	ACPS350	ACPS400
Manual Actuators		ACMS150	ACMS200	ACMS250	ACMS300	ACMS350	ACMS400
Electric Motor Actuators		ACPS150	ACPS200	ACPS2503	ACPS3003	ACPS350	ACPS400
Slide Valve	SV Q/C 150	✓					
	SV Q/C/R 200		✓				
	SV Q/C 250			✓			
	SV Q/C/R 300				✓		
	SV Q/C 350					✓	
	SV Q/C 400						✓

ACMS MANUAL ACTUATORS

ACMS series manual levers are produced for slide valves, offering a problem-free and long service life.

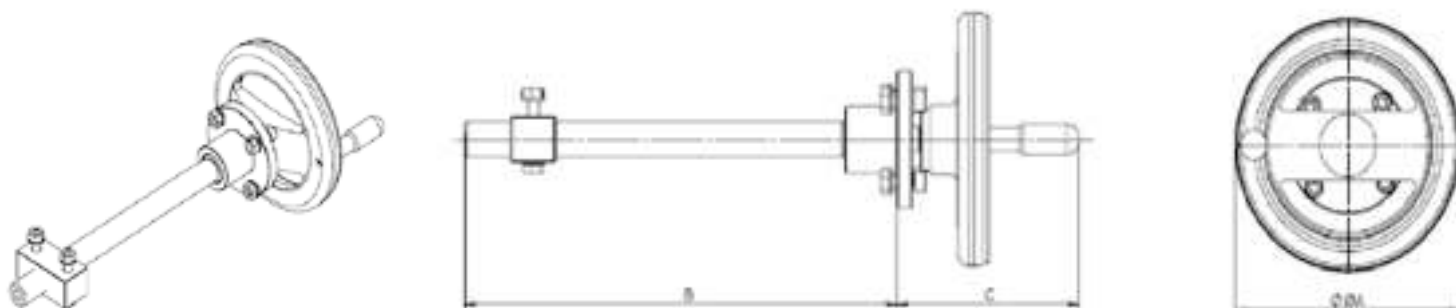

Type	ØA (mm)	B (mm)	C (mm)	Weight (kg)
ACMS150	200	216	162	1.7
ACMS200	200	269	162	2.2
ACMS250	200	313	162	2.5
ACMS300	200	384	162	3.4
ACMS350	200	428	162	5.0
ACMS400	200	478	162	5.4

ACPS PNEUMATIC ACTUATORS

ACPS series pneumatic levers are produced for slide valves and complete with pneumatic piston and mounting elements.

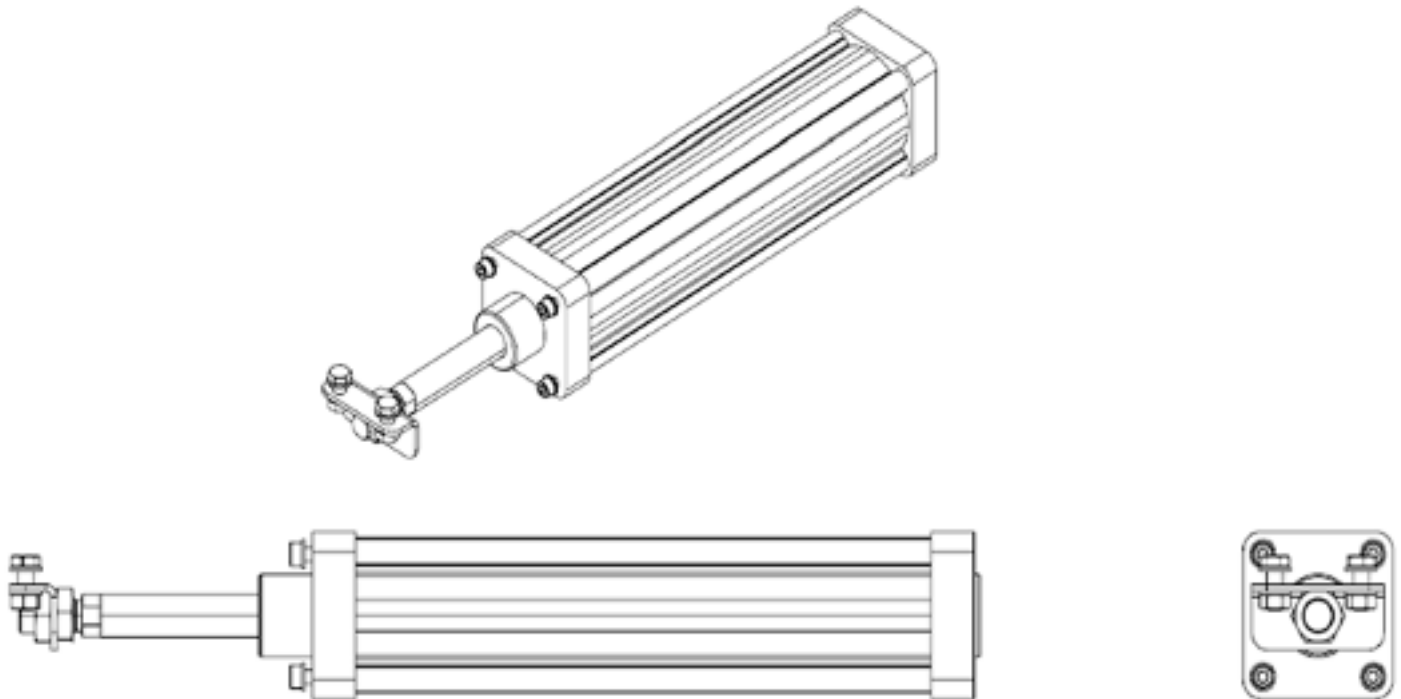

Type	ØPneumatic Cylinder (mm)	B (mm)	Weight (kg)
ACPS150	63	140	2.8
ACPS200	80	200	4.0
ACPS250	80	250	4.4
ACPS300	80	300	4.8
ACPS350	100	350	7.1
ACPS400	100	400	7.7

ACES ELECTRIC MOTOR ACTUATORS

ACES series electric motor actuators are produced for slide valves and complete with electromotor gear-box, shaft and mounting elements.

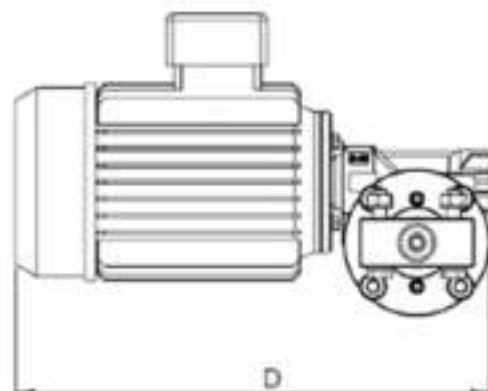
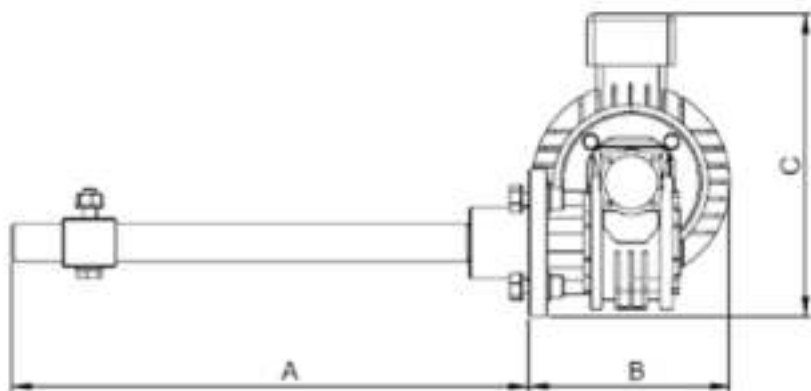
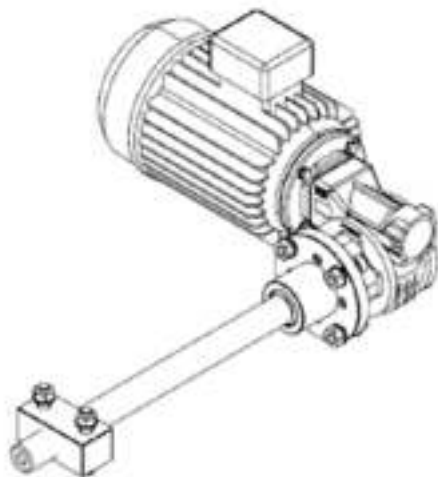

Type	Torque (Nm)	Opening Time (sn)	Motor Power (kW)	Revolution (rpm)	A (mm)	B (mm)	C (mm)	D (mm)	Weight (kg)
ACES150	36	27	0.37	67	217	150	225	353	6.9
ACES200	36	35	0.37	67	267	150	225	353	7.2
ACES250	36	44	0.37	67	316	150	225	353	7.4
ACES300	36	52	0.37	67	384	150	225	353	7.8
ACES350	36	63	0.37	67	427	150	225	353	8.9
ACES400	36	73	0.37	67	480	150	225	353	10.2